

5350 SOLID FLANGE REACTION TORQUE TRANSDUCER (U.S. & METRIC)

FEATURES & BENEFITS

- Threaded mounting holes
- Compact size
- Optional ± 10 VDC output available on 100 ozf-in and above

STANDARD CONFIGURATION



MODEL 5350 (Shown)

SPECIFICATIONS

ACCURACY – (MAX ERROR)		
Nonlinearity – %FS		± 0.1
Hysteresis – %FS		± 0.1
Nonrepeatability – %RO		± 0.05
TEMPERATURE		
Compensated Range	$^{\circ}\text{F}$	+75 to +175
	$^{\circ}\text{C}$	+24 to +80
Operating Range	$^{\circ}\text{F}$	-65 to +225
	$^{\circ}\text{C}$	-54 to +107
Effect on Output – % /deg	$^{\circ}\text{F}$	± 0.002
Effect on Zero – %RO / deg	$^{\circ}\text{F}$	± 0.002
ELECTRICAL		
Rated Output – mV/V (Nominal)	10 ozf-in	2.0
	0.07 Nm	1.3
Bridge Resistance – Ohm (Nominal)		350
Excitation Voltage – VDC MAX		10
MECHANICAL		
Calibration		CW & CCW
Safe Overload – %CAP		200
Material		Aluminum

PERFORMANCE PARAMETERS

CAPACITY		TORQUE OVERLOAD		TORSIONAL STIFFNESS (FROM FLANGE FACE-TO-FACE)		WEIGHT		MAX THRUST LOAD		MAX BENDING MOMENT		MAX SHEAR LOAD			
ozf-in	Nm	ozf-in	Nm	ozf-in/rad	Nm/rad	oz	kg	ozf	N	ozf-in	Nm	ozf	N		
10	1.13	20	2.26	650	73.5	0.5	0.2	40	178	10	1.13	10	44.5		
20	2.26	40	4.52	1.8K	203			80	356	20	2.26	20	2.26	20	89
50	5.65	100	11.3	7.4K	836			200	890	50	5.65	50	5.65	50	222
100	11.3	200	22.6	13.4K	1.51K	1.2	0.5	100	445	50	5.65	50	222		
200	22.6	400	45.2	37.5K	4.24K			200	890	100	11.3	100	11.3	100	445

5350 SOLID FLANGE REACTION TORQUE TRANSDUCER (U.S. & METRIC)

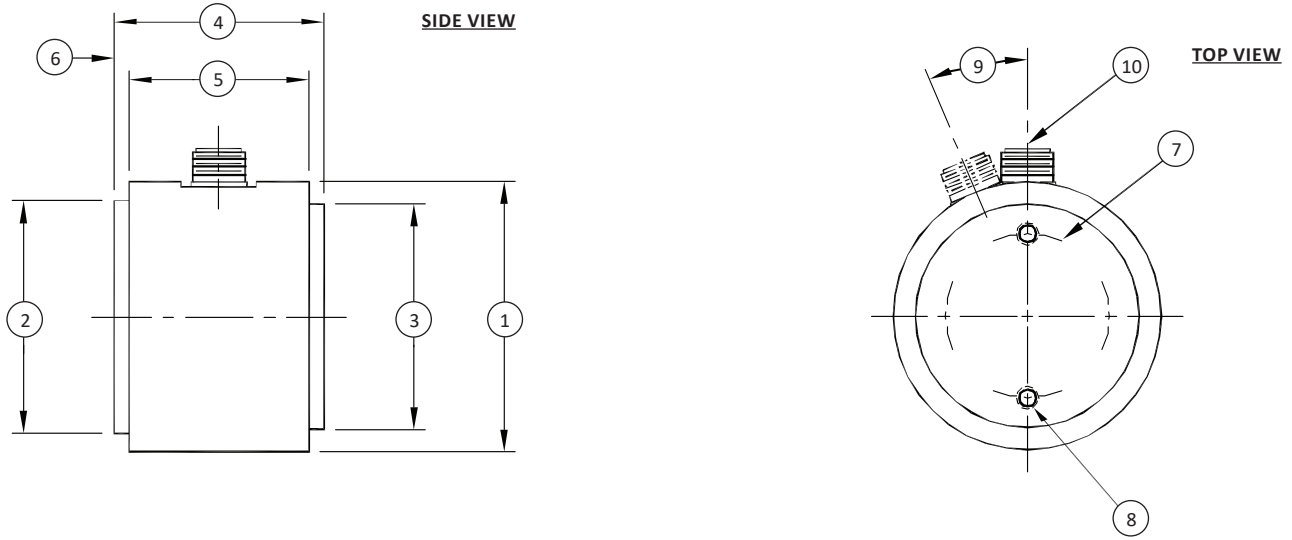

DIMENSIONS

See Drawing	CAPACITY	
	U.S. (ozf-in)	Metric (Nm)
	10, 20, 50, 100, 200	0.07, 0.14, 0.35, 0.71, 1.41
	in	mm
(1)	Ø1.50	Ø38.1
(2)	Ø1.00	Ø25.4
(3)	Ø0.875	Ø22.225
(4)	1.50	38.1
(5)	1.375	34.925
(6)	0.0625	1.5875
(7)	Ø0.563	Ø14.3002
(8)	#4-40 UNC-2B 2 places	
(9)	0°	
(10)	Conxall 7282-6PG-300	