

TS17 HEX DRIVE REACTION TORQUE TRANSDUCER (U.S. & METRIC)

FEATURES & BENEFITS

- Capacities from 0.1 to 20 Nm (0.07 to 177 lbf-in)
- Simple operation - no moving parts
- Useful for auditing fastener torques
- Quick-connect chuck

SPECIFICATIONS

ACCURACY – (MAX ERROR)		
Combined Error – %FS		± 0.1
Nonrepeatability – %		± 0.05
TEMPERATURE		
Effect on Zero – %RO / deg	°C	±0.02
Effect on Output – % / deg	°C	±0.01
Rated Range	°C	+5 to +50
	°F	+41 to +122
Operating Range	°C	-10 to +60
	°F	+14 to +140
ELECTRICAL		
Output – mV/V	0.2 - 5 Nm	1
	1.77 - 44.3 lbf-in	
	10 - 20 Nm	2
	88.5 - 177 lbf-in	
Excitation Voltage – VDC MAX		12
Bridge Resistance – Ohm		350
Cable Length – m		3
MECHANICAL		
Safe Overload – %RO		130
Material		Alloy steel



MODEL TS17 (Shown)

OPTIONS

- 100% Control Signal (RCAL)

ELECTRICAL CONNECTION

Wire	6-PIN ELECTRICAL CONNECTION	
	Function	
Green	Excitation (-)	
Brown	Excitation (+)	
Yellow	Shield	
White	Signal (+)	
Grey	Signal (-)	
Shield	Control signal (option)	

PERFORMANCE PARAMETERS

CAPACITY		SPRING RATE	MOMENT OF INERTIA – J (Kg•m ²)		MAX THRUST LOAD		MAX SHEAR FORCE	
Nm	lbf-in	NM/rad	Drive Side	Test Side	N	lbf	N	lbf
0.1	0.89	1.8x10 ¹	6.7x10 ⁻⁷	5.7x10 ⁻⁷	43	9.7	0.6	0.13
0.2	1.78	1.8x10 ¹	6.7x10 ⁻⁷	5.7x10 ⁻⁷	43	9.7	0.6	0.13
0.5	4.43	1.1x10 ²	6.7x10 ⁻⁷	5.7x10 ⁻⁷	95	21.4	1.2	0.27
1	8.85	1.1x10 ²	6.7x10 ⁻⁷	5.7x10 ⁻⁷	380	85.4	3.7	0.83
2	17.7	1.9x10 ²	6.8x10 ⁻⁷	5.7x10 ⁻⁷	380	85.4	3.7	0.83
5	44.3	3.7x10 ²	6.9x10 ⁻⁷	5.8x10 ⁻⁷	700	157	9.5	2.14
10	88.5	3.7x10 ²	6.9x10 ⁻⁷	5.8x10 ⁻⁷	1.15K	259	19	4.3
20	177	4.8x10 ²	7.1x10 ⁻⁷	6.0x10 ⁻⁷	1.15K	259	19	4.3

U.S. dimensions and capacities are provided for conversion only. Standard products have International System of Units (SI) capacities and dimensions.

TS17 HEX DRIVE REACTION TORQUE TRANSDUCER (U.S. & METRIC)

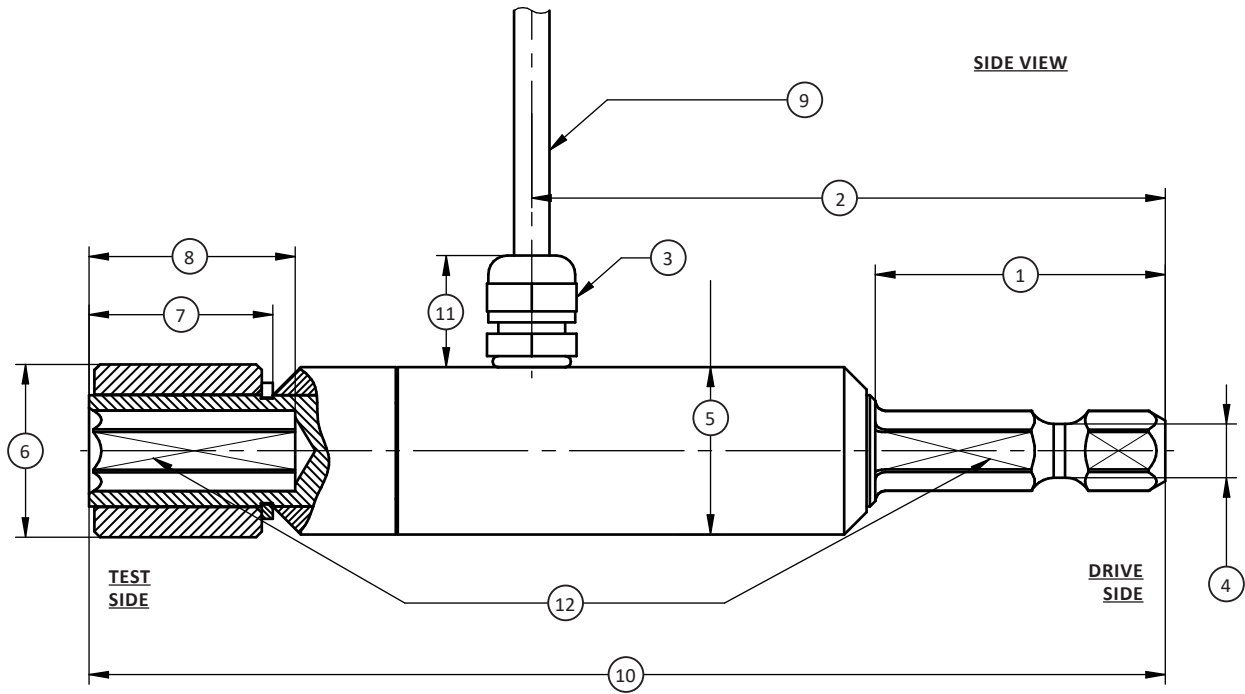

DIMENSIONS

See Drawing	CAPACITY	
	Metric (Nm)	U.S. (lbf-in)
	0.1, 0.2, 0.5, 1, 2, 5, 10, 20	0.07, 0.15, 0.37, 0.7, 1.5, 3.7, 88.5, 177
	mm	in
(1)	26 ^{+0.2}	1.0 ^{+0.008}
(2)	57	2.2
(3)	SW 8	
(4)	∅4.8 ^{-0.1}	∅0.19 ^{-0.004}
(5)	∅15	∅0.6
(6)	∅15.5	∅0.61
(7)	16.5	0.65
(8)	18.5	0.73
(9)	∅3.2	∅0.13
(10)	96.5	3.80
(11)	10	0.4
(12)	∅1/4"	